



CITYSCENE
& BRICKWORKS

Gerflor[®]
theflooringgroup



CITYSCENE & BRICKWORKS

Cityscene & Brickworks are tufted loop pile carpet tiles that can be used together to create interesting and contemporary floor schemes. Suitable for a wide range of environments including commercial office, education and healthcare.

CONTENTS

Colourways.....	1
Commercial Office Scheme	2-3
Floor Plan	4-5
Education Scheme	6-7
Floor Plan	8-9
Installation	10-11
Scheme	12-13

CITYSCENE & BRICKWORKS

Colourways

CITYSCENE



Tin 21 07501
LRV 17.12



Shale 21 07503
LRV 11.13



Granite 21 07505
LRV 8.39



Claystone 21 07502
LRV 12.54



Rhyolite 21 07504
LRV 9.92



Basalt 21 07506
LRV 3.25

BRICKWORKS



Ironstone 22 06707
LRV 7.90



Tonbridge 22 06711
LRV 4.49

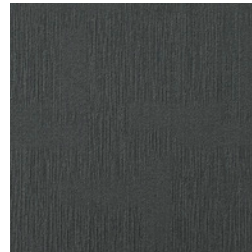

Himley 22 06709
LRV 3.05

Cityscene



Broadloom

Cityscene Brickworks



Quarter Turn

Cityscene Brickworks



Brick Bond

COMMERCIAL OFFICE SCHEME

Cityscene | Brickworks



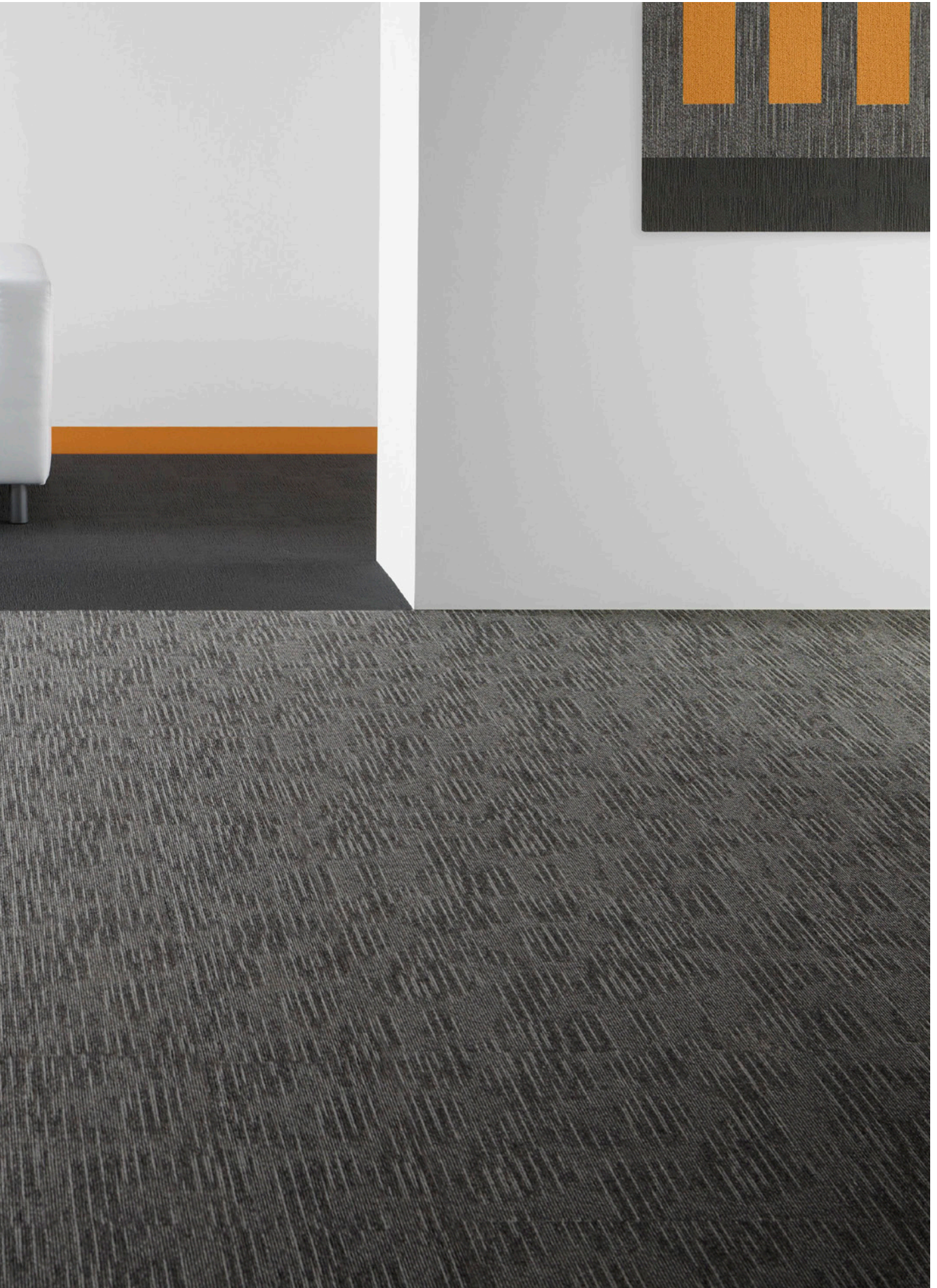



COMMERCIAL OFFICE FLOOR PLAN

Cityscene | Brickworks

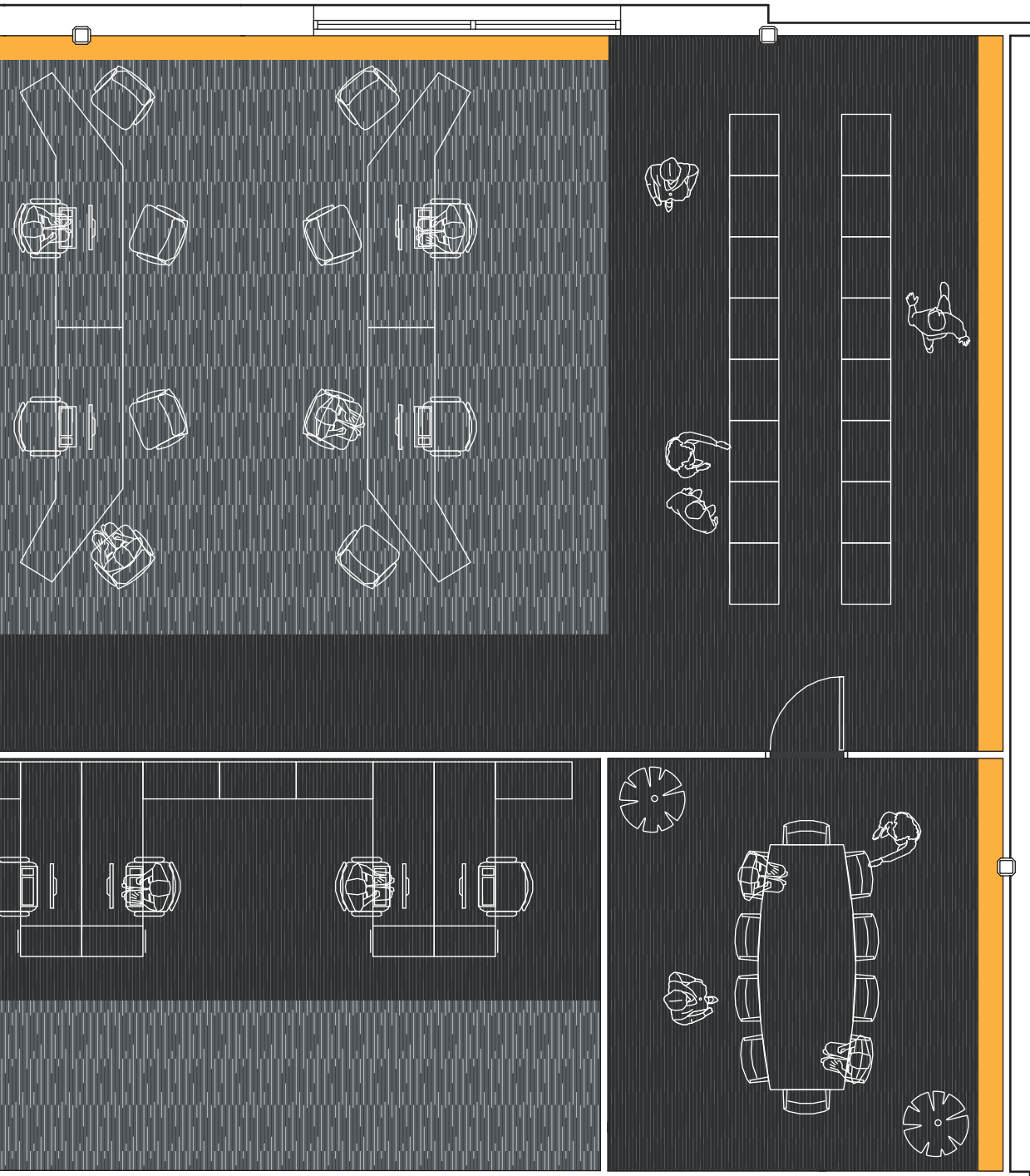





 Cityscene
 Granite 21 07505
 (Installed brick bond)

 Brickworks
 Himley 22 06709
 (Installed brick bond)

EDUCATION SCHEME

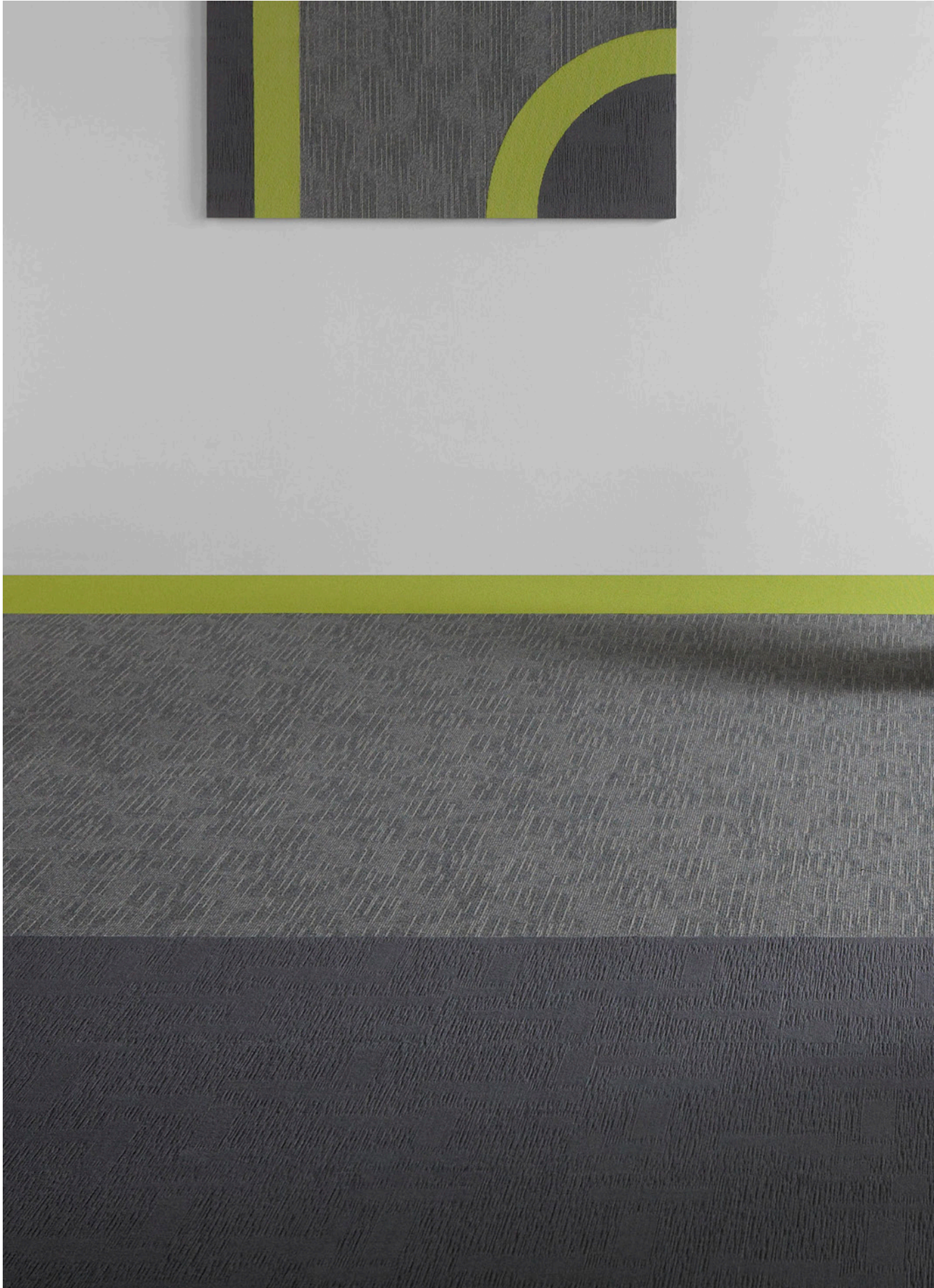
Cityscene | Brickworks





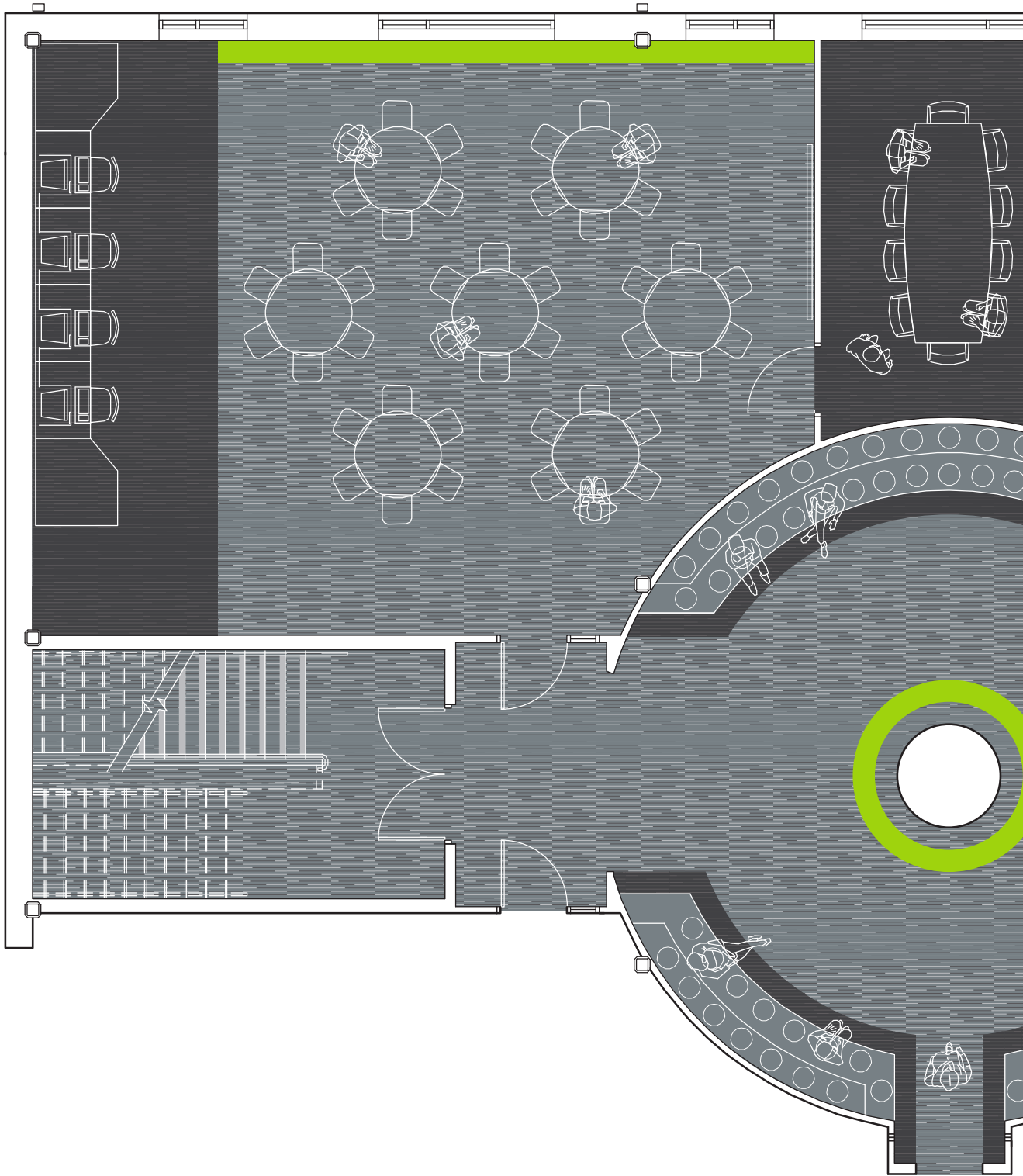

EDUCATION FLOOR PLAN

Cityscene | Brickworks

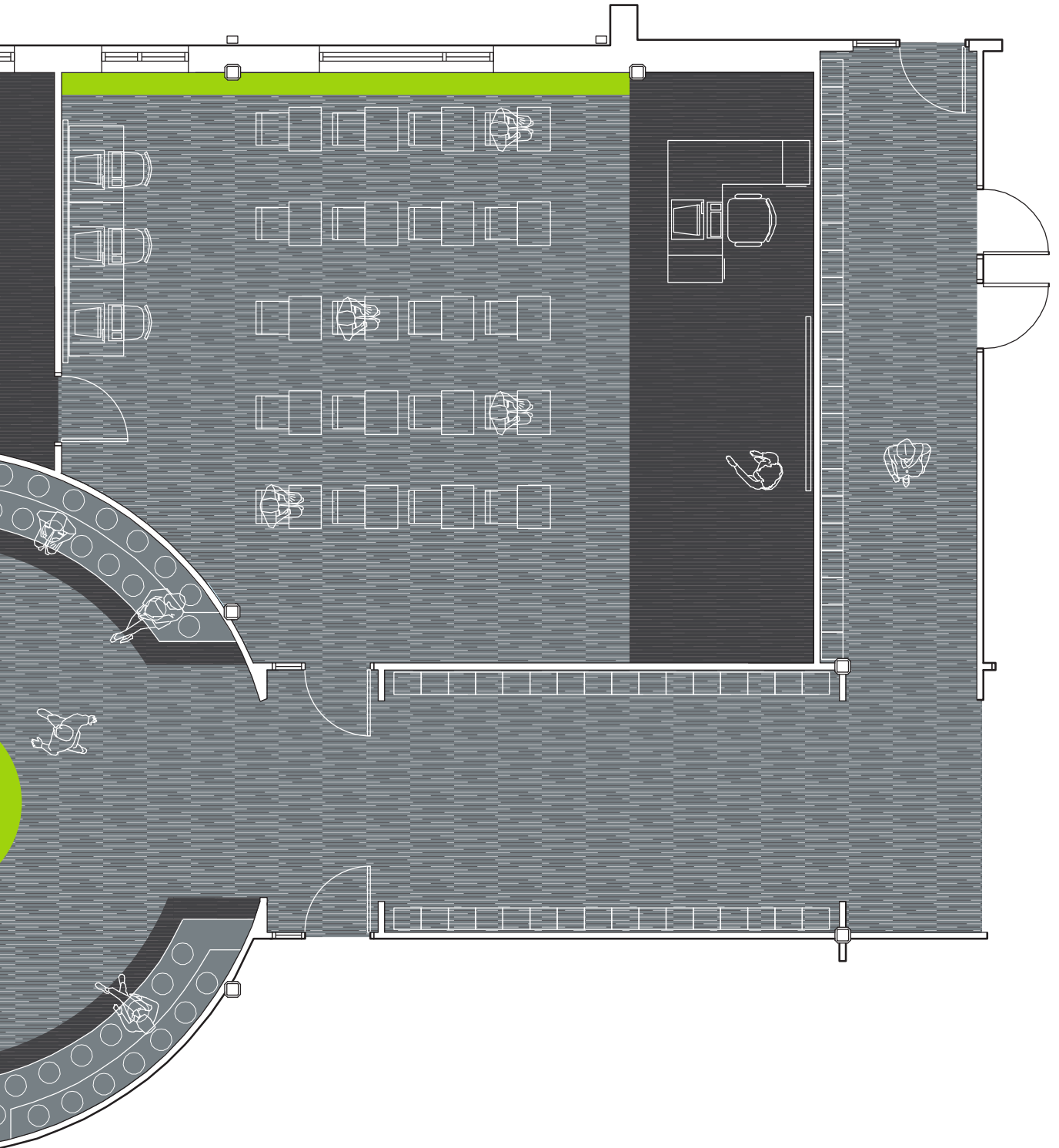



 Cityscene
Shale 21 07503
(Installed brick bond)

 Brickworks
Tonbridge 22 06711
(Installed brick bond)

CITYSCENE & BRICKWORKS INSTALLATION

Cityscene | Brickworks

Image shows 12 tiles

Cityscene



Quarter Turn

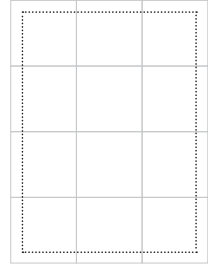

Cityscene Shale 21 07503 with Brickworks Tonbridge 22 06711

Image shows 12 tiles

Cityscene



Brick Bond

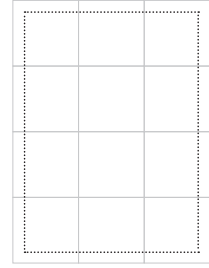

Cityscene Granite 21 07505 with Brickworks Himley 22 06709

CITYSCENE & BRICKWORKS SCHEME

Cityscene | Brickworks





Uniclass Pr_35_57_11_62
CI/SfB (43) Tn6

CITYSCENE

BRICKWORKS

SPECIFICATION

Product Format	Tile	Tile
Product Dimensions	500mm x 500mm	500mm x 500mm
Product Construction	Tufted Loop Pile	Tufted Textured Pattern Loop Pile
Surface Yarn	100% Solution Dyed Nylon	100% Solution Dyed Nylon
Total Carpet Weight	3880 g/m ²	4030 g/m ²
Tufted Pile Weight	650 g/m ²	800 g/m ²
Gauge	1/12" (47.2 per dm)	1/12" (47.2 per dm)
Stitches	47.5 per dm	50.5 per dm
Primary Backing	Non-woven	Non-woven
Secondary Backing	Bitumen (contains 75% recycled material)	
Total Carpet Thickness	5.8mm	6.5mm

PERFORMANCE SPECIFICATION

Classification BS EN 1307	Class 33	Class 33
Castor Chair BS EN 985 Test A	Pass	Pass
Static Electricity ISO 6356	<2kV	<2kV
Impact Sound Insulation EN ISO 10140-3	26dB	26dB

FLAMMABILITY

BS EN 13501-1	Class Bfl-s1	Class Bfl-s1
---------------	--------------	--------------

WARRANTIES

Wear Warranty	10 Year	10 Year
Anti-static Warranty	10 Year	10 Year

ADHESIVES

For recommended adhesives contact Technical Services.



EPD - awaiting validation

The information contained in this document is valid from 1/7/2023 and is subject to change at any time without notice.

Contact us to order free samples

UNITED KINGDOM:

Gerflor Flooring UK Ltd
Park Green, Macclesfield,
Cheshire, SK11 7LZ
Tel: 01625 428922
E-mail: contractuk@gerflor.com
Visit: www.gerflor.co.uk

IRELAND:

Gerflor Ltd
Ballybay Road, Co. Monaghan,
A81 YD83, Republic of Ireland
Tel: +353 (0) 42 966 1431
E-mail: gerflorirl@gerflor.com
Visit: www.gerflor.ie